

AHUJA[®]**PORTABLE PA AMPLIFIER SYSTEM**
50W RMS

PSX-600DP

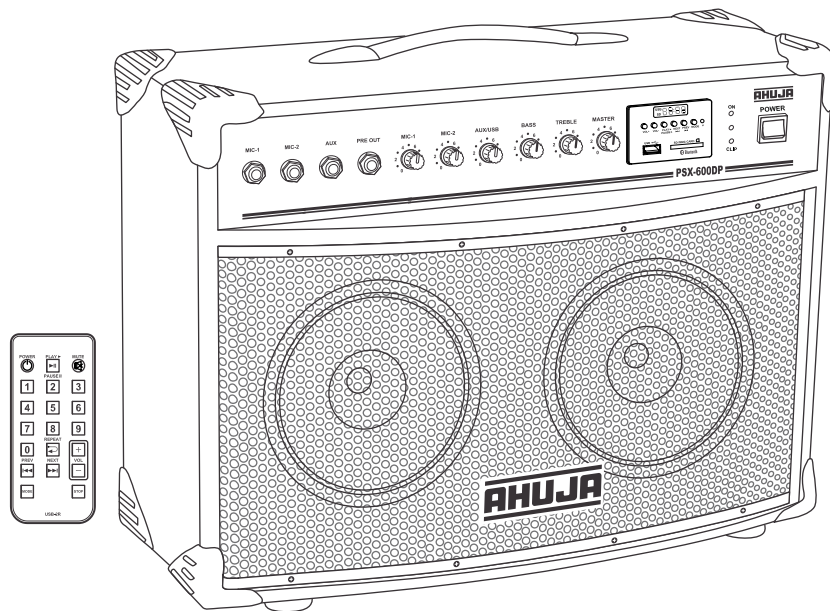

FEATURES

- Designed for use in a wide variety of PA and Musical Instrument applications.
- PSX-600DP has two unbalanced Mic inputs and one Aux input.
- Built-in Bluetooth MP3 Player.
- Pre amp output is provided for recording the program, connecting to booster amplifiers or to another Powered Speaker.
- Built-in 2 × 8" / 8 ohm high quality full range speakers.
- Active Bass and Treble controls for proper shaping of frequency levels.
- A Clip LED for monitoring the output and to caution overdrive.
- Operation on AC mains & 12V DC power source (car battery).

-
- ◆ Thank you for purchasing the AHUJA Portable PA Amplifier System.
 - ◆ Please read this manual thoroughly before making connections and turning on the power. Following the instructions in this manual will enable you to obtain optimum performance from your new AHUJA Portable PA Amplifier System.
 - ◆ Please retain this manual for future reference.

• Front Panel Controls & Description

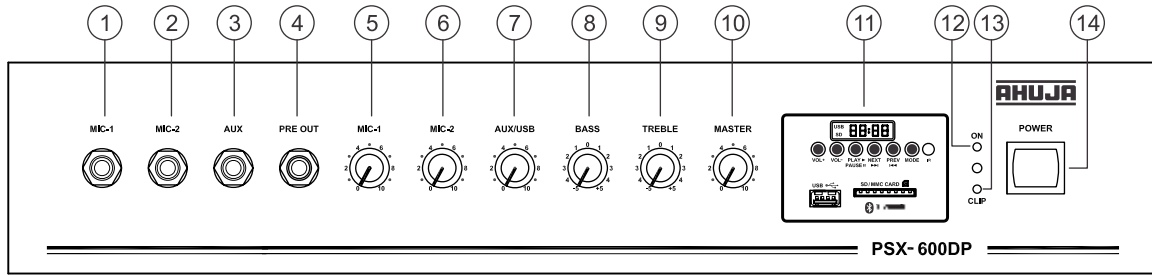

1. **MIC-1 Input Jack Socket**
2. **MIC-2 Input Jack Socket**
3. **AUX Input Jack Socket**
For accepting an unbalanced signal from an auxiliary source like a Cassette Player, CD Player, Keyboard, Echo Mixer etc.
4. **PREAMP OUT Jack Socket**
For connecting to the Aux input of an amplifier, a Powered Speaker or a Cassette Recorder for recording purpose.
5. **MIC-1 Volume Control**
6. **MIC-2 Volume Control**
7. **AUX/USB Volume Control**
8. **BASS Control**
For attenuating or boosting the signal level of low frequencies.
9. **TREBLE Control**
For attenuating or boosting the signal level of high frequencies.
10. **MASTER Volume Control**
For adjusting the overall volume level of the powered speaker.
11. **MP3 Playback Facility** (For details see page no. 3)
12. **Power LED**
This LED glows when the power is switched on.
13. **CLIP LED**
This LED glows when the output is at clipping level. Reduce the signal level of this LED is continuously glowing.
14. **POWER Switch**
Push the top part of the knob to switch the amplifier ON. Push the bottom part of the knob to switch the amplifier OFF.

• Rear Panel Controls & Description

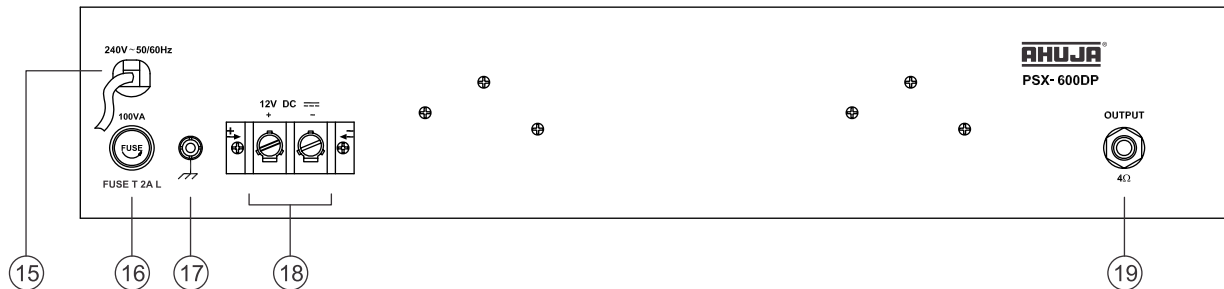

15. **3 Core AC Mains Cable with Plug**
16. **AC Mains Fuse Rating 2 AMP. 250V (T 2A L)**
This protects the amplifier from any excessive current flow.
17. **Earth Terminal**
18. **Battery Terminal Block**
For connecting 12V Car Battery as standby power source. In case of mains failure automatic change over to battery operation gives smooth functioning of the programme.
19. **Internal Speaker Connector**
The internal speakers are connected to the output jack socket of the built-in amplifier through a pre-wired ¼" phone plug which is factory fitted. *User should not remove or alter this connection. If the connector is removed, then there will be no sound output.*

CAUTION

- To reduce the risk of electric shock, do not unscrew the amplifier section from cabinet. No user serviceable parts inside.
- Before replacing any fuse, make sure the set is switched OFF and disconnect from AC mains or any other power source. Replace a fuse only with another of exactly same specification.

• MP3 Playback Facility: Controls & Features

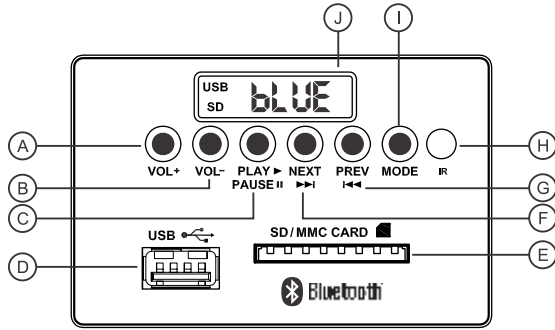

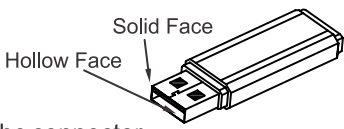
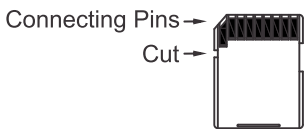
- A. VOL+ :** To increase volume level of MP3 player.
- B. VOL- :** To decrease volume level of MP3 player.
- C. ►|| PLAY/PAUSE:** Press PLAY/PAUSE once to Pause if music is already playing. Press PLAY/PAUSE again to resume playing.
- D. USB Connector:** Insert the USB drive here. While inserting USB drive into the USB connector, hold the USB drive in such a way that hollow part of the USB drive is downwards as shown in Figure. Any forceful insertion in wrong direction will damage the connector.
- 
- E. SD/MMC Card Connector:** Insert the SD/MMC Card into its appropriate slot to play. When taking out the card, pull the card to take out.
- 
- While inserting SD/MMC card into the slot, ensure that the card is inserted in such a way that all pins are facing upward and cut is towards left as shown in figure.
- F. ►► Next:** Press NEXT to select next forward music track. Pressing NEXT repeatedly will move the system to successively next forward tracks.
- G. ◀◀ Prev:** Press PREV to Select the previous track. Pressing PREV repeatedly will move the system to successively previous tracks.

- H. IR Sensor:** Picks up signal from the Remote control. Point the Remote control toward this sensor for best results.
- I. Mode:** To select USB, SD or Bluetooth input.
- J. LED Display:** Shows blue in default condition displays 3 digits of the track selected to play i.e 001 to 999. During play, displays the time duration of the track played.

Remote Control

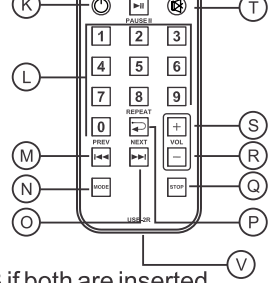
- 
- K. Power:** Press once to switch off MP3 digital player, press again to switch ON.
- L. Number key 0 to 9.** To choose the track number to be played.
- M. ◀◀ :** To select the previous track.
- N. MODE :** To select SD or USB if both are inserted.
- O. ►► :** Press to select the next track.
- P. ↻** Press once to repeat the song being played. Press again to repeat all the songs.
- Q. STOP:** Press to stop the track being played.
- R. Vol-:** Press to decrease the volume of Digital Player.
- S. Vol+:** Press to increase the volume of Digital Player.
- T. MUTE:** Press once to mute the sound, press again the resume the sound.
- U. ►|| PLAY/PAUSE:** Press Play/Pause once to Pause when music is already playing. Press Play/Pause again to resume playing.
- V. Battery Replacement:** Pull out the battery tray and replace the battery with positive electrode facing upwards as shown in fig. below. Push the battery compartment back to the close position. Use CR2025 or equivalent lithium coin cell.

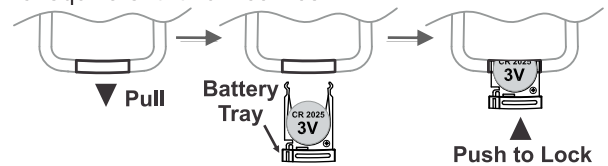

• Operation

- Make necessary interconnections with the PSX-600DP and set all the volume controls to '0' position and plug in the AC power cord to AC mains socket.
- Turn the power 'ON' which is indicated by power LED glow.
- Use Mic, Aux or USB input as desired and set the corresponding volume controls and master control for optimum result.
- Set the Bass & Treble controls to suit the acoustics of surroundings.
- To use bluetooth it is necessary to do PAIRING of PSX-600DP and mobile or laptop bluetooth devices. The pairing is done as follows:

- (a) Select the bluetooth mode of mobile/laptop etc. and press 'Search'. Moment it receives the PSX-600DP device by name TDM011 or BTSPKR, press 'Select'. The system is ready to use the moment a pulse tone is heard in PSX-600DP.
- (b) Play the desired music or other MP3 file from mobile. It is played through PSX-600DP. Some times in some handsets, while pairing, password is asked. Press 0000 for password and pair the selected device to use.

Note: It will not pair other devices simultaneously unless we switch off the bluetooth device already in use or take away the paired device beyond PSX-600DP receiver range.

• Safety Instructions

Retain the Instructions: Please retain this Instruction Manual for future reference.



This symbol, wherever it appears, alerts you to the presence of uninsulated hazardous voltage that may be sufficient to constitute a risk of electric shock. External wiring to any terminal marked with this symbol must be done by a trained and instructed person only.



This symbol, wherever it appears adjacent to a component, alerts you that the concerned component can only be replaced by another of the exact same specifications.

- **Water and Moisture:** In order to prevent any fire or shock hazard, do not expose this equipment to rain or moisture.
- **Power Source:** The equipment should be connected to a 220-240V 50Hz AC or 12V DC power source.
- **Power-cord Protection:** Do not cut, kink, damage or modify the power supply cord supplied with the

equipment. Keep the power supply cord away from heaters & harmful chemicals. Do not place heavy objects on the power cord.

- **Operation on Generator:** When operating the powered speaker on a generator, make sure it is switched 'OFF' till the generator voltage has stabilized and then only switch the powered speaker 'ON'.
- **Protection Against Shocks:** Do not plug in or remove the power supply plug with wet hands so as to avoid electric shock.
- **Replacing AC Mains Fuse:** After disconnecting the AC mains and rectifying the defect in the amplifier, change the fuse with another of the specified rating only.
- **Grounding or Earthing:** The equipment must be earthed properly before operating it to avoid electric shock. An EARTH terminal is provided on the rear panel for this purpose.
- **Exposure to Hot Region:** Do not touch the Heat Sink (Rear Panel) while the amplifier is in operation.

STAND MOUNTING

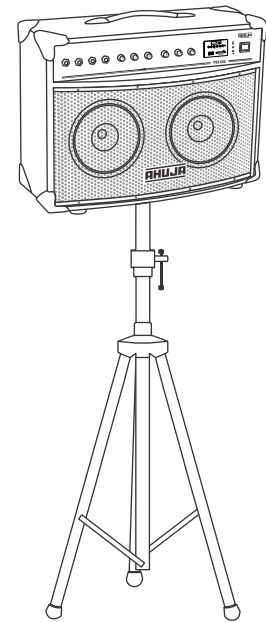

PSX-600DP mounted on speaker stand STA-150 / STA-100

• Specifications

Power Output	40W RMS at 1% THD 50W RMS at 5% THD
Input Channels	2 × Mic 0.65mV/4.7kΩ (Mic source impedance 50Ω-1kΩ) 1 × Aux 200 mV/330kΩ
Frequency Response	50-18,000Hz ±3dB
S/N Ratio	60dB
Tone Controls	Bass: ±5dB at 100Hz Treble: ±5dB at 10kHz
Pre Amp Output	200mV/600Ω
Protections	AC: Fuse 2 Amp. 250V (T 2A L), DC: Fuse 8 Amp. (T 8A L)
MP3 Playback	Built-in Bluetooth MP3 Player (USB, SD and MMC card) Remote Control provided
Power Supply	AC : 220V-240V 50/60Hz DC : 12V Car Battery
AC Power Consumption	100VA
Dimensions	W530 x H430 x D235 mm
Weight	15.70 kg

Design and Specifications are subject to change without notice owing to continuous product up-gradation. Technical specifications are subject to production tolerances.

We cannot be held responsible for printing errors, should they occur. AHUJA is a registered trademark of Ahuja Radios in India and other countries.

© Copyright Ahuja Radios, 2014. All rights reserved. Any unauthorized reproduction or use of logos, images or design elements is strictly prohibited by law.

No part of this compilation may be reproduced in any manner or translated without written permission.

AHUJA RADIOS

215, Okhla Industrial Estate, New Delhi-110020, INDIA
C-45, Phase-II, Noida-201305 (UP) INDIA
Tel.: +91-11-26831549, 41612474 Fax: +91-11-26847287
E-mail: ahuja@ahujaradios.com Website: www.ahujaradios.com