

XPA-3010DP

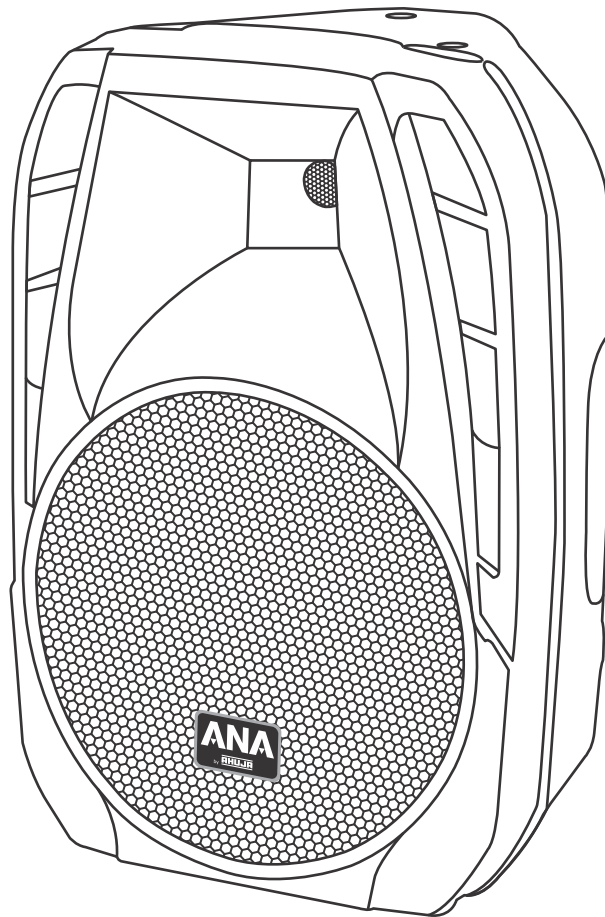

- ◆ Thank you for purchasing the AHUJA Portable PA Amplifier System.
- ◆ Please read this manual thoroughly before making connections and turning on the power. Following the instructions in this manual will enable you to obtain optimum performance from your new AHUJA Portable PA Amplifier System.
- ◆ Please retain this manual for future reference.

• Safety Instructions

Read the Instructions: Please read all the instructions in this section carefully before installation or use of the product. All the safety instructions must be followed.

Retain the Instructions: Please retain this Instruction Manual for future reference.



This symbol, wherever it appears, alerts you to the presence of uninsulated hazardous voltage that may be sufficient to constitute a risk of electric shock. External wiring to any terminal marked with this symbol must be done by a trained and instructed person only.



This symbol, wherever it appears adjacent to a component, alerts you that the concerned component can only be replaced by another of the exact same specifications.

WARNING

- To reduce the risk of electric shock, do not remove the back cover. No user serviceable parts inside. Refer all servicing to qualified personnel only.
- Before replacing any fuse, make sure the set is switched off and disconnected from the AC mains or any other power source. Replace a fuse only with another of exactly same specification.

CAUTIONS

Water & Moisture: Do not insert or remove the AC mains plug with wet hands.

Power Source: The voltage & frequency of the AC mains supply to which this set can be connected, is marked on the rear panel of the set. Do not connect this set to any power source other than those specified on the rear panel.

Power Cord Protection: Do not cut, kink, damage or modify the AC power cord supplied with this set. Keep the AC power cord away from heaters and harmful chemicals. Do not keep any heavy object on the power cord.

Operation on Generator: When operating this set on a generator, make sure the set is switched off till the generator voltage has stabilized.

Stability: This set must be kept in a stable and flat position, and never in a tilted position. This set can also be mounted on a stand. Before using any stand, check its strength and stability.

Cleaning: Disconnect this equipment from the AC mains before cleaning. Clean with a damp cloth, but do not allow any liquid to enter the set. Do not clean with liquids or aerosols.

• Table of Contents

Contents	Page No.
• Rear Panel Controls Description	4
• MP3 Playback Facility: Controls & Features	5
• Device Pairing	6
• Interconnection	7
• Specifications	8

• Features/General Description of Product

- XPA-3010DP is a Portable PA Amplifier System with built-in 250W amplifier, speaker and bluetooth MP3 player.
- Plastic moulded cabinet designed for use in a wide variety of PA and Musical Instrument applications.
- XPA-3010DP has three Mic inputs, one Aux input (alternate to MIC-3), and Line input.
- MIC-1 has priority over the other mic inputs and Aux input. When an adequate signal is present on MIC-1 input, the other MIC, AUX & USB inputs are muted. This allows announcements to be conveniently made by interrupting any music which may be playing without operating any switch or control. For using this feature, keep MIC-1 PRIORITY switch ON.
- Built-in MP3 player with remote control, USB, SD/MMC card reader and Bluetooth facility.
- Line output is provided to connect to line input of another XPA-3010DP.
- Built-in 12"/8 ohm high quality woofer with Dynamic horn tweeter.
- Active Bass/Treble controls for proper shaping of frequency levels to suit the applications.
- CLIP LED for monitoring the output & caution against overdrive.
- Protection provided for DC offset, output short and overdrive conditions.

• Rear Panel Controls Description

1. Line Input Jack Socket

To connect the line out of another XPA-3010DP. Also for connecting a mixer.

2. Line Output Jack Socket

For connecting to the Line input of another XPA-3010DP. This allows two nos XPA-3010DP sets to operate on the same signal.

3. Push Selector Switch for Mic-3/Aux

Keep the switch unpressed when connecting a mic to the MIC-3/AUX socket. Keep the switch pressed when using an AUX level signal. LED Glow indicates the AUX or Mic-3 input selected.

4. Mic-3/Aux Volume Control

5. Mic-3/Aux Input Jack Socket

6. Mic-2 Volume Control

7. Mic-2 Input Jack Socket

8. Mic-1 Volume Control

9. Mic-1 Input Jack Socket

This input has priority over other MIC and AUX inputs. When a signal is present on MIC-1 input, the other MIC AUX & USB inputs are muted (provided PRIORITY switch is ON).

10. AC Socket with built in 4A Fuse (T 4A L)

11. DC fuse holder (– Supply)

12. DC fuse holder (+ Supply)

13. 12V DC OUTPUT SOCKET

For connecting wireless microphone which works on 12V DC and less then 250mA current consumption. 12V DC constant is available upto 500mA current consumption.

14. Fault LED

This LED glows when any +/-DC fuse blows. This may happen because of output shorting, DC offset or overdrive.

15. Power Switch

Push the top part of the knob to switch the amplifier ON. Push the bottom part of the knob to switch the amplifier OFF.

16. Power LED

This LED glows when the power is switched on.

17. Clip LED

This LED glows when the output is at clipping level. If this LED glows continuously, reduce the signal level.

18. Master Volume Control

For adjusting the overall volume level of the amplifier.

19. Treble Control

For cutting or boosting the signal level of high frequencies.

20. Bass Control

For cutting or boosting the signal level of low frequencies.

21. Priority ON/OFF Switch

Push this switch to use MIC-1 priority. LED will glow when priority is active. Keep the switch in unpressed position if priority feature is not required.

22. MP3 Playback Facility (see page no 5.)

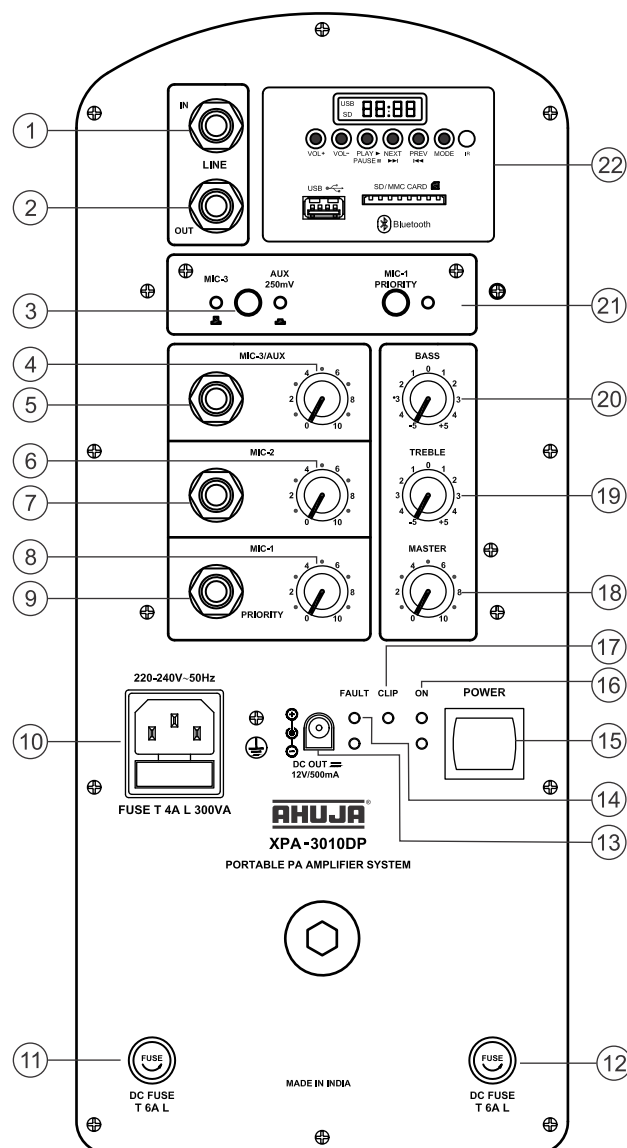

• MP3 Playback Facility: Controls & Features

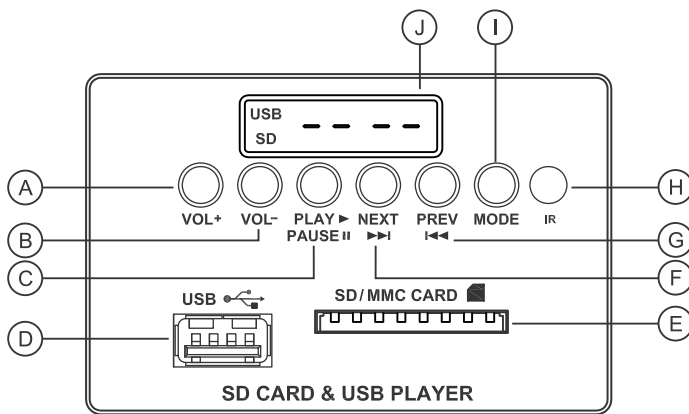

- A. **VOL+ :** To increase volume level of MP3 player.
- B. **VOL- :** To decrease volume level of MP3 player.
- C. **▶|| PLAY/PAUSE:** Press PLAY/PAUSE once to Pause if music is already playing. Press PLAY/PAUSE again to resume playing.
- D. **USB Connector:** Insert the USB drive here. While inserting USB drive into the USB connector, hold the USB drive in such a way that hollow part of the USB drive is downwards as shown in Figure.

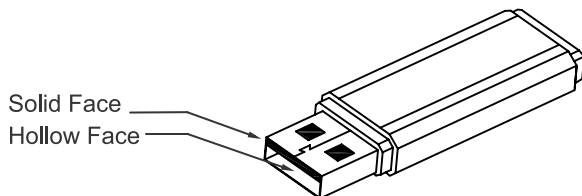

Any forceful insertion in wrong direction will damage the connector.

- E. **SD/MMC Card Connector:** Insert the SD/MMC Card into the slot to play. When taking out the card, push the card to take out.

While inserting SD/MMC card into the slot, ensure that the card is inserted in such a way that all pins are facing upward and cut is towards left as shown in figure.

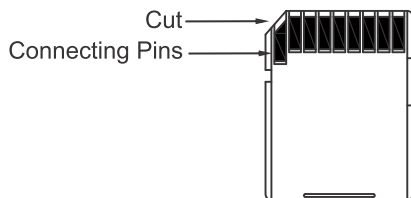

- F. **▶▶ Next:** Press NEXT to select next forward music track. Pressing NEXT repeatedly will move the system to successively next forward tracks. Then press PLAY/PAUSE for playing the track so selected.
- G. **◀◀ Prev:** Press PREV to Select the previous track. Pressing PREV repeatedly will move the system to successively previous tracks.
- H. **IR Sensor:** Picks up signal from the Remote control.

Remote Control

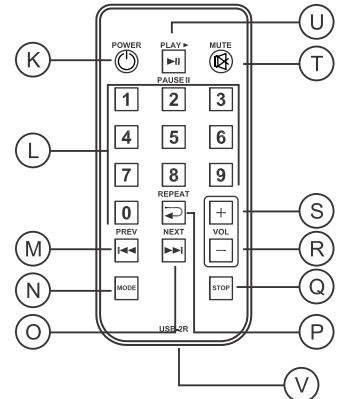

Point the Remote control toward this sensor for best results.

- I. **Mode:** To select USB, SD or Bluetooth when USB SD both are inserted. Default condition of the set is “ _ _ _ ”
- J. **LED Display:** Instantly displays 3 digits of the track selected play to i.e 001 to 999. During play, display the time duration of the track played.

Remote Control

- K. **Power:** Press once to switch off MP3 player, press again to switch ON.
- L. Number key 0 to 9. To choose the track number to be played.
- M. **◀◀ :** To select the previous track.
- N. **MODE :** To select SD, USB or Bluetooth Option.
- O. **▶▶ :** Press to select the next track.
- P. **↺** Press once to repeat the song being played. Press twice to repeat all the songs.
- Q. **STOP:** Press to stop the track being played.
- R. **Vol:** Press to decrease the volume of MP3 Player.
- S. **Vol:** Press to increase the volume of MP3 Player.
- T. **MUTE:** Press once to mute the sound, press again to resume the sound.
- U. **▶|| PLAY/PAUSE:** Press Play/Pause once to Pause when music is already playing. Press Play/Pause again to resume playing.
- V. **Battery Replacement:** Pull out the battery tray and replace the battery with positive electrode facing upwards as shown in fig. below. Push the battery compartment back to the close position. Use CR2025 or equivalent lithium coin cell.

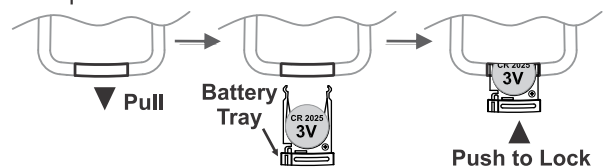

• Pairing of Bluetooth Device

SWITCH ON the amplifier. If no USB or SD card is connected, the Default condition of the MP3 digital Player is “_ _ _ _”. Press Mode Key once to select the Bluetooth function. The display shows "bBLUE. If USB or SD Card is already playing the Display shows USB or SD than also press mode switch once to select the Bluetooth function.

To play the MP3 programme from mobile phone or laptop, the PAIRING of the Bluetooth devices of mobile phone & Amplifier is necessary.

Pairing is done as follow :-

SELECT the Bluetooth option in Mobile Phone or laptop & follow the instruction as appearing on mobile/laptop.

Normally the following general instructions are followed *:

Press ACTIVATE /ON/DISCOVERABLE/SEARCH, etc, as applicable in the mobile phone or laptop used.

The mobile phone or laptop starts searching for the new Bluetooth device. The moment Bluetooth appears on the mobile phone or laptop, select the new device i.e. Bluetooth and press OK or allow it to appear on mobile. System is ready to use.

In some mobiles, it asks for a code to allow access. Press 0000 and follow the steps, like pressing "OK", "Allow once", "Allow always" etc. and make the device ready for use.

Select the MP3 programme from mobile phone or laptop and press PLAY. The same song starts playing on the Ahuja Portable Amplifier. We can SELECT Volume, FF, Rewind, Play/Pause function either from keys on the Amplifier or through Remote Control.

Note:

- a) It is not necessary that all functions of remote control will be activated through Bluetooth and compatibility varies from mobile to mobile.
- b) Some mobile phones/computers may require a different procedure. Please read the user manual of the phone/computer.

• Interconnection of Multiple XPA-3010DP

1. Connect the microphone or AUX signal to the respective input of first XPA-3010DP.
2. Connect the Line output of first XPA-3010DP to Line input of next XPA-3010DP and so on.
3. The output level of each XPA-3010DP can be controlled from its individual master control.
4. Bass, Treble control setting, if needed, will be done from 1st XPA-3010DP only.
5. For undistorted sound, ensure that CLIP LED does not glow continuously.

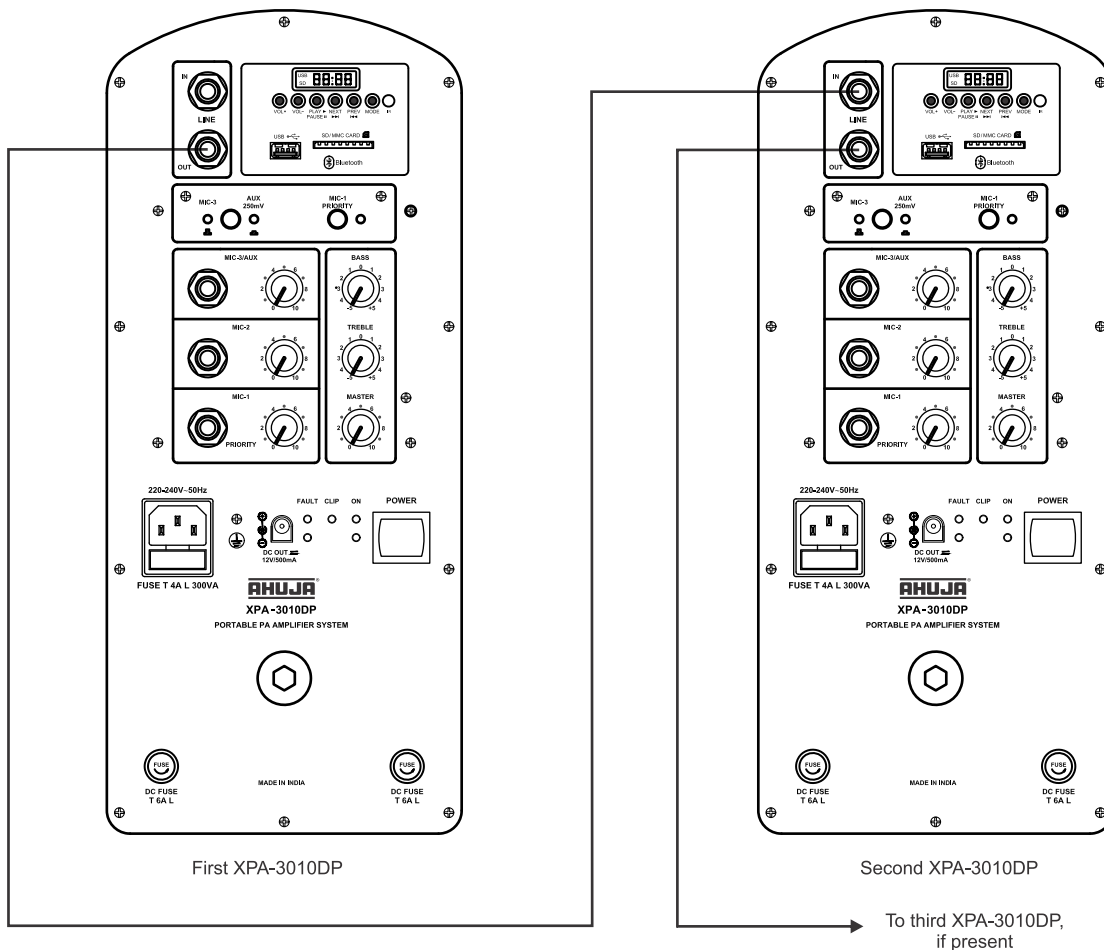

• Specifications

Power Output	250W RMS at 1% THD 200W RMS at 0.5% THD
Output Regulation	Better than 0.5 dB
Input Channels	3 x Mic 2.0mV / 4.7k Ω (Priority with MIC-1) (Mic source impedance 50 Ω -1k Ω) 1 x Aux 250mV / 470k Ω 1 x Line input : 1V / 10k Ω
Frequency Response	35-20,000 Hz \pm 3dB
S/N Ratio	60 dB
Tone Controls	Bass : \pm 5dB at 100Hz Treble : \pm 5dB at 10kHz
Mp3 Playback	MP3 Player with USB, SD/MMC card reader and Bluetooth
Protection	AC Fuse 4 Amp. 250V (T 4A L) DC 2 x 6 Amp. 250V (T 6A L)
Line Output	1V / 1k Ω
DC Output	12V / 500mA
Power Supply	AC : 220-240V 50-60Hz
AC Power Consumption	300 VA
Dimensions	W385 \times H585 \times D305 mm
Weight	21.00kg approx.

Design and Specifications are subject to change without notice owing to continuous product up-gradation. Technical specifications are subject to production tolerances.

We cannot be held responsible for printing errors, should they occur. **AHUJA** is a registered trademark of Ahuja Radios in India and other countries.

© Copyright Ahuja Radios, 2017. All rights reserved. Any unauthorized reproduction or use of logos, images or design elements is strictly prohibited by law.

No part of this compilation may be reproduced in any manner or translated without written permission.

E. & O. E. 0K/10/17

AHUJA RADIOS

215, Okhla Industrial Estate, New Delhi-110020, INDIA
C-45, Phase-II, Noida-201305 (UP) INDIA
Tel.: +91-11-26831549, 41612474 Fax: +91-11-26847287
E-mail: ahuja@ahujaradios.com Website: www.ahujaradios.com